

ttdsoft – WA Premium and WAM Pro

Step 10 - Check USB Drive playing in Android Smart TV or Smart Projector or smart panel

- 10-1. Put encrypted USB Drive in Android Smart TV or Projector or Smart panel
- Install Android Player apk [app] in these device from
 - [1] USB Drive
 - Install player apk from usb drive
 - [2] Google store
 - Search - "ttdsoft player" and install it in smart tv or projector or smart panel

10-1 [a] ttdsoft player in google play store for Android Smart TV or Projector or Smart panel.

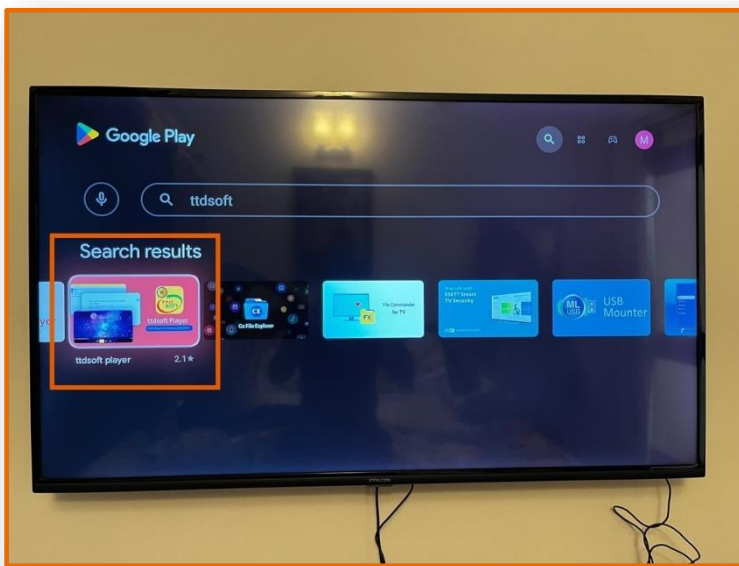

10-1 [b] ttdsoft player app installation at Android Smart TV or Projector or Smart panel.



10-2. After app installation this icon will appear in your TV or Projector or Panel.



10-3. TAP on this icon [touch screen or remote or control panel], your playlist will appear.

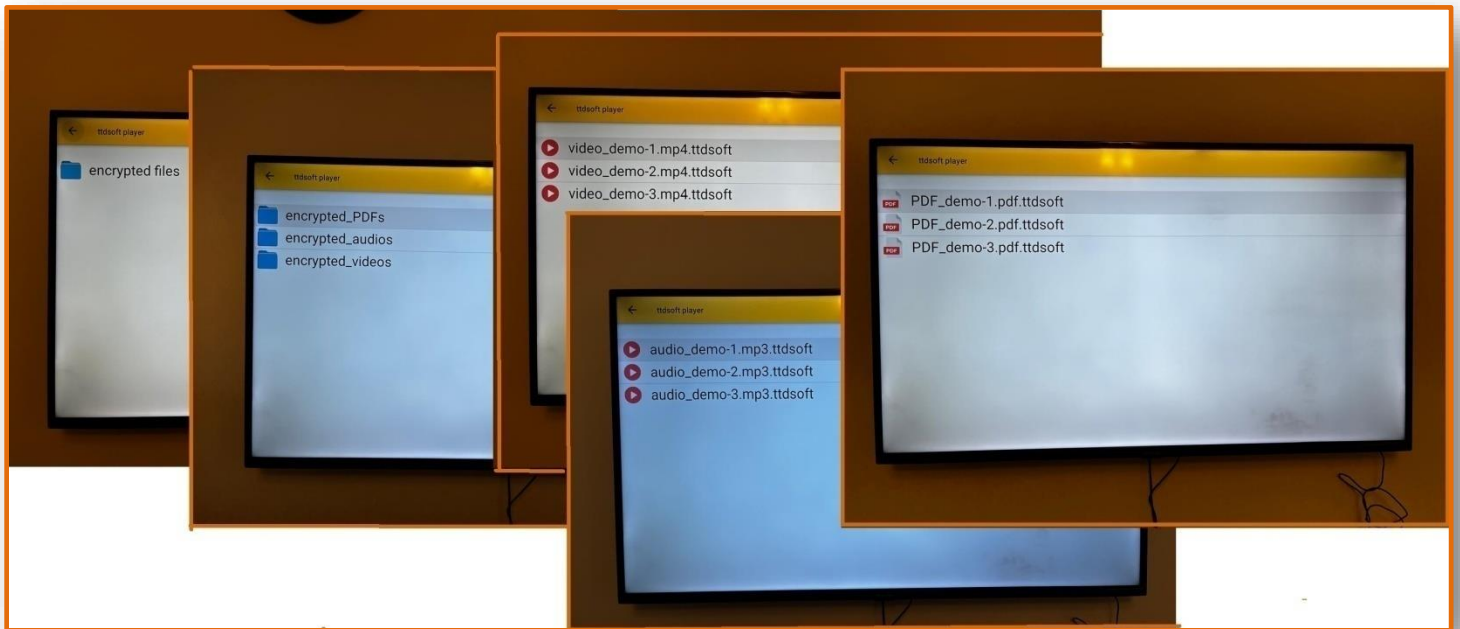

10-4. Select Videos, Audios and PDFs and enjoy play all
Check all files in your Smart TV, Smart Projector or Smart Panel.

Note - We have taken these snap shot by external device.
These may have low **picture quality**.

In folder "my_encrypted_videos" there are three encrypted video files, check all these files.



Video_full_ver-1.mp4.ts



Video_full_ver-2.mp4.ts

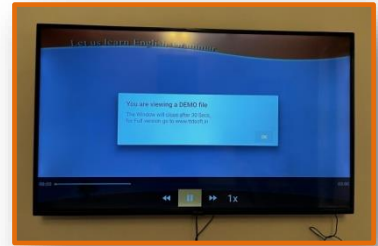

Video_full_ver-3.mp4.ts

In folder "my_encrypted_PDFs" there are three encrypted PDF files, check all these files.

Note - We have taken these snap shot by external device. These may have low picture quality.



PDF_full_ver-1.pdf.ts

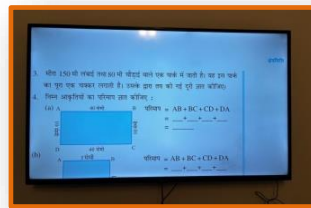

PDF_full_ver-2.pdf.ts

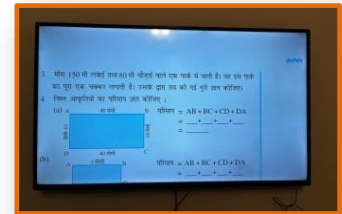

PDF_full_ver-3.pdf.ts

In folder "my_encrypted_audios" there are three encrypted audio files, check all these files.

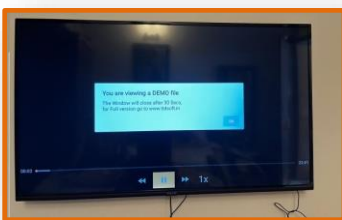

audio_full_ver-1.mp3.ts

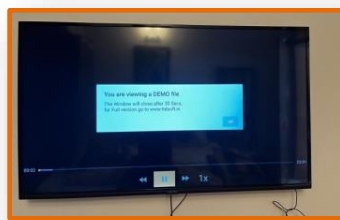

audio_full_ver-2.mp3.ts



audio_full_ver-3.mp3.ts